

The Instant Impresario Guitar Instruction Guide

(Everything you need to know to get playing right away!)

First Things First: This guitar can either be powered by the AC Adapter (included) or via eight AA batteries. But beware! We strongly recommend that you use Alkaline batteries (such as Duracell or Energizer), because some types of rechargeable batteries are a tiny bit larger than Alkalines, and can easily get stuck in the battery compartment.

Okay, so let's get you playing your guitar right away. We'll introduce more features and details a little later on. Start by turning the guitar "On" using the rocker switch on the instrument's bottom. Now have a look at the "lead sheet" below:

Happy Birthday

The image shows a musical score for the song "Happy Birthday" in 3/4 time. It consists of three staves of music. Above each staff are guitar chord diagrams for C, G, and F chords. The lyrics are written below the notes. The first staff has the lyrics "Hap - py Birth - day to you! Hap - py". The second staff has the lyrics "Birth - day to you! Hap - py Birth - day dear". The third staff has the lyrics "[Name here] Hap - py Birth - day to you!".

This "Lead Sheet" is typical of sheet music for any popular song. The words and the notes are for the singer (so don't worry if you can't read music), and the tabs (above the notes) are for the guitar player. The tabs are designed to show you what fingers go on what strings, however this Guitar has no strings so you can completely ignore them and pay attention *only* to the letters above (such as C, G, and F in the "Happy Birthday" example).

Want to play a "C" chord? Press the "C" button on the neck of the guitar and strum. Congratulations! You now sound like an experienced guitar player. Now do the same thing for the G and F chords. Woo-hoo! Okay, now you can accompany anyone singing "Happy Birthday" using just these three chords. These same chords make up about 90% of all 1950's rock, nearly all country music, and every Neil Diamond song ever written, so you're off to a really great start.

Here are the 4 chords needed for Bob Dylan's "Blowin' in the Wind"; presented in a more informal shorthand: Chords on top, lyrics on bottom:

C F C Am
How many roads must a man walk down

C F G7
Before you call him a man?

C F C Am
How many seas must a white dove sail

C F G7
Before she sleeps in the sand?

C F C Am
Yes, how many times must the cannon balls fly

C F G7
Before they're forever banned?

F G7 C Am
The answer my friend is blowin' in the wind

F G7 C
The answer is blowin' in the wind.

Pretty easy, huh?

Your Impresario guitar was designed so that you can pick up ANY sheet music that has guitar chords on it and instantly be able to play the song. (A tall order, since there are so many different kinds of chords!) Below is a table showing how to get the modified chords (such a 7th, a Major 7th, or a Suspended 4th – very popular chord variations):

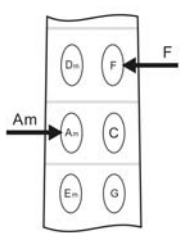
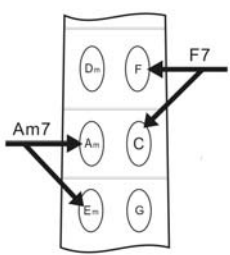
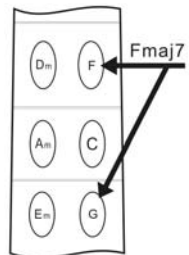
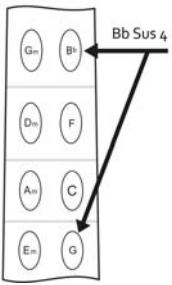
<p>To get a Major or a Minor chord, just press the corresponding letters printed on the guitar neck.</p> 	<p>To get a 7th chord, also press the button below the chord you want.</p> 	<p>To play a Major 7th chord, also press 2 buttons below the chord you want.</p> 	<p>Suspended 4th chords are rare, but if you ever need to play one, then also press 3 buttons below the chord you want.</p> 
--	---	--	--

That's it! You can now play 99% of all sheet music ever published. To help you with immediate gratification, we've compiled a small booklet of more than 25 songs (chords and lyrics, written in the informal shorthand) which you can download for free off the web: <http://xaphoon.com/guitarsongs.pdf> . If you want more, you can just google "<song name> guitar chords lyrics" and marvel at all the free online sheet music there is, no matter what your taste in music.

Electric Guitar

This guitar can also sound like an electric guitar. On the neck of the guitar you'll find a button labeled "EG" (Electric Guitar). Press it once to enter Electric guitar mode; press it again to go back to rich acoustic. Unleash your inner Jimi Hendrix!

I. MAIN PART NAMES

1. Front Part

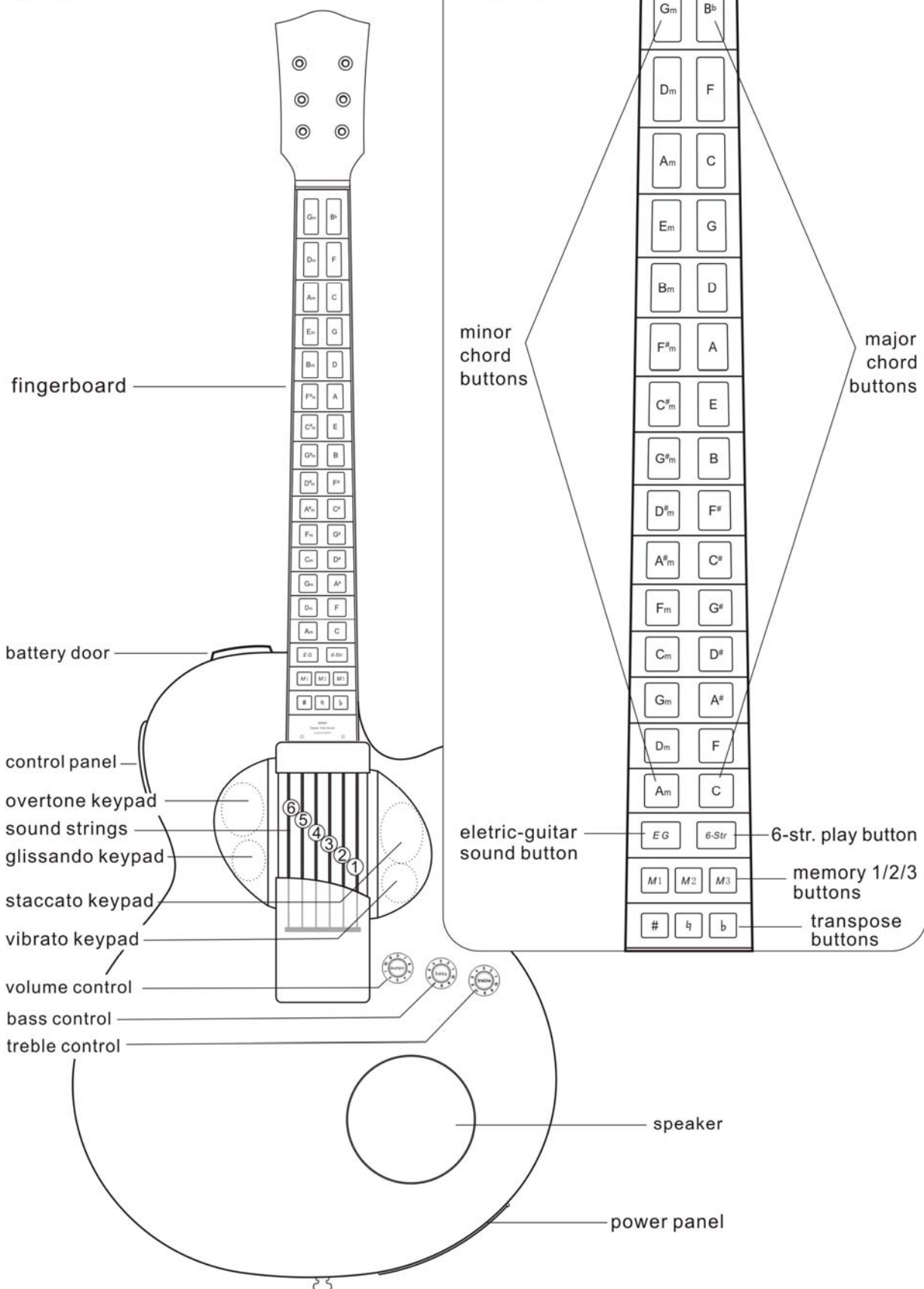

2. Control Panel

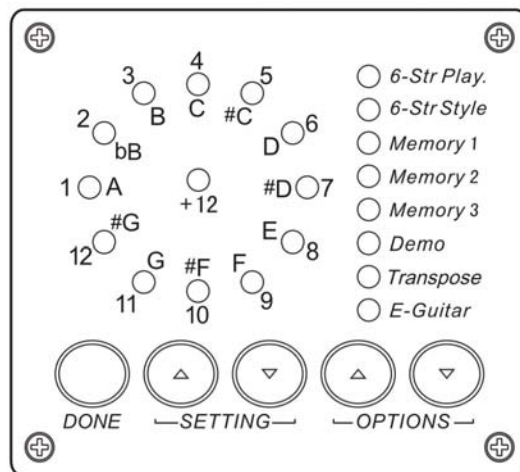

Other Features

So let's take a minute and talk about some of the guitar's other features. See those shiny black pick guards on the left and right side of the strings? They're actually touch-sensitive switches. The one to the right of the strings hosts two such switches (see diagram): the top one is the "Pickguard" which is better thought of as a "kill switch": it stops the sound after you've strummed (the equivalent of putting your hand on the strings to stop them from vibrating). The bottom area is a vibrato button, which works very similarly to how a vibrato bar works on an electric guitar.

The two touch-sensitive switches to the left of the strings also hosts two switches: The top one changes the sound to what's called the "Harmonics" effect (where the sound is about an octave higher than normal); the bottom half provides a sound that's difficult to describe but it definitely gives your strumming some additional style. Try them all!

The 6-Str button

Here's another very cool feature. On the neck of the guitar you'll find a button labeled 6-Str (6th String). Press it once to turn it on. (A red light on the control panel will turn on, indicating that this mode is enabled.) In 6th String mode, you only need to pluck the string closest to you (String #6) multiple times to get an arpeggio effect, as if you were plucking the strings one by one. There are a total of 24 arpeggio effects; you can change what you hear by doing the following:

- Press the "Option" UP and DOWN buttons until the "6-Str Style" light illuminates.
- Press the "Setting" UP and DOWN buttons to select one of 24 variations. (After you go through the first 12, the light in the center of the circle lights up, indicating that you should add "12" to each of the choice numbers.)

Try all of the styles to get a feel of what they sound like. If you can read music, you can see what the different styles are at the end of this guide.

Demo Songs

There are also 20 Demo songs built into the computer which will impress your friends. To invoke them, do the following:

- Press the "Option" UP and DOWN buttons until the "Demo" light illuminates.
- Press the "Setting" UP and DOWN buttons to select a Song.
- At this point, you can start pressing any of the strings to start playing the demo song at your own tempo. (NOTE: The guitar strings actually sense when you press down and then remove pressure on the string.

Technically it doesn't sense strumming. Use this knowledge to make the demo song go faster!)

- f. (Alternatively, you can hit the DONE button and the guitar will start to play the demo for you.)
- g. Try Demo Song #15, "Flight of the Bumblebee", and challenge yourself to press and release the strings as fast as you can! ☺
- h. You can enable the sound of the melody during Demo mode by pressing the "C" chord button on the neck of the guitar as you hit the strings.

Demo No.	Song Name
1	Red River Valley
2	El Condor Pasa
3	God Rest Ye Merry Gentlemen
4	Yankee Doodle
5	Old Black Joe
6	Old Folks At Home
7	Oh Susanna
8	Donna Donna
9	Home On The Range
10	Brother John (Are You Sleeping?)
11	Tom Dooley
12	Puff the Magic Dragon
13	Love Romantic
14	Greensleeves
15	Flight of the Bumblebee
16	Catch Me (Shumann)
17	Minuet in G (Beethoven)
18	Russian Dance (Tchaikovsky)
19	Minuet in G
20	Suite no1 Bourree (Bach)

More Guitar Features

Have a look at the control panel on the side of the guitar. The right two buttons ("Options Down" and "Options Up") control which of the eight option modes you can change: "6-Str Play" through "E-Guitar".); once a mode is selected you can modify it by pressing either of the "Setting" buttons.

We've already talked 6-Str Play, 6-Str Style, and Demo. What do the rest of these functions do?

Transpose

This essentially makes everything you play sound higher or lower in pitch. Let's say you've learned a song pretty well, and want to play along with a recording of that song. But that recording is either higher or lower than what you're playing (i.e., the recording was made in a different key). The solution is the Transpose function: When the Transpose red light is on, just use the SettingUP and DOWN buttons to change the pitch of what you're playing to match that of the recording. Or, if you're playing with a singer but the singer doesn't have a vocal range to match what you're playing, just use the transpose function to make your pitch higher or lower. The guitar has 12 different settings, representing every possible key. One of the settings will surely be one that your singer can sing with ease.

But there's an even easier (and perhaps more intuitive) way to invoke the Transpose function. On the neck of the guitar are three buttons: **#** (sharp), **b** (flat), and **n** (natural). Each time you press the **#** button, everything you play sounds half a step higher. Similarly, every time you press the **b** button everything you play sounds half a step lower. So you can keep pressing these buttons until what you play matches what you're trying to play with. Want to go back to playing "normally" (without transposing)? Just hit the **n** button once.

Memory Keys

Sometimes, like when playing on stage for instance, it would be very handy to be able to instantly recall a 6-string setting on demand. The Digital Guitar gives you three different memory locations to store this setting.

To set a memory style, press the Options buttons until one of the memory location lights is lit. Then choose the 6-str style you want, and then press “Done”. Your setting has now been stored, and you can recall any of the 3 locations instantly by pressing the M1-M3 buttons on the neck of the guitar. The memory is retained even if the guitar is powered off.

The Bottom of the Guitar

The bottom of the guitar contains the following input and output ports:

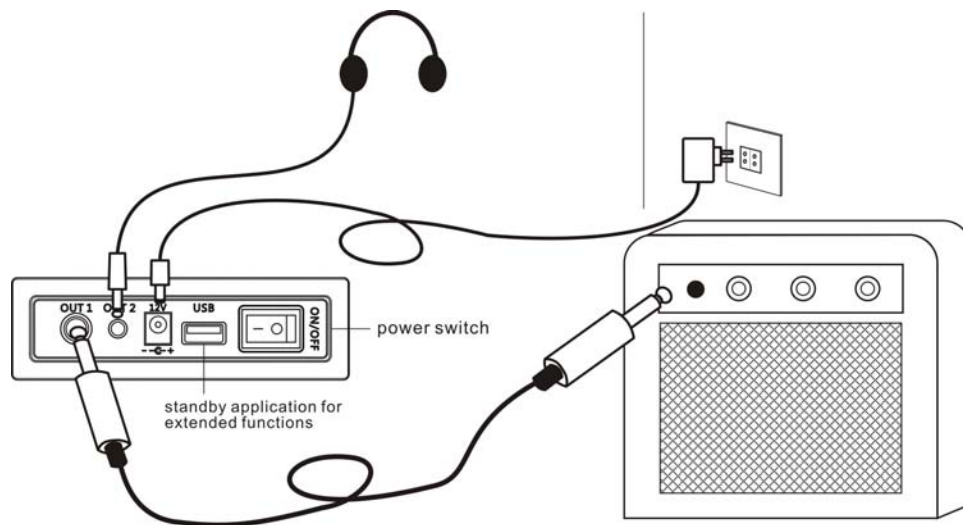

Here's what they do:

- OUT 1 is a “Audio Line Out” designed to channel your guitar’s sound into professional recording equipment.
- OUT 2 is designed for earphones or ear buds (iPhone ear buds work great). So you can practice and jam all night long without disturbing anyone.
- 12V is where you plug in the AC adapter which came with your guitar.
- USB is a port reserved for future use.
- And the On/Off switch is just that.

Other Technical Stuff

Power supply	12V, 8 batteries of AA size
	DC Power supply, 12V, 1000 mA, inside positive and outside negative.
power consumption	< 150 mA in the standby state
	Max. 800 mA when on and cranked up all the way
External dimensions	102cm (L) x 38cm (W) x 9cm (H)
Weight	≤ 2.4kg (without the weight of the batteries)
Accessories	AC adapter, this instruction manual.

The 24 6-Str Styles

If you can read music, here's a notation of what the 24 6th-String styles will play when invoked:

The image displays 24 musical staves, each representing a different 6-string style. The staves are arranged in three columns of eight. Each staff contains a series of 'x' marks on the lines and spaces of a six-line staff, indicating specific fret positions. The patterns vary significantly between styles, with some showing simple sequences and others showing more complex, dense clusters. Styles 19 and 20 include curved arrows above the staff, likely indicating a bend or a specific playing technique. Style 21 features four upward-pointing arrows, possibly indicating a tremolo or a specific rhythmic pattern. Styles 22, 23, and 24 show very dense clusters of 'x' marks, suggesting sustained or complex harmonic structures.